

CAROLINE COUNTY

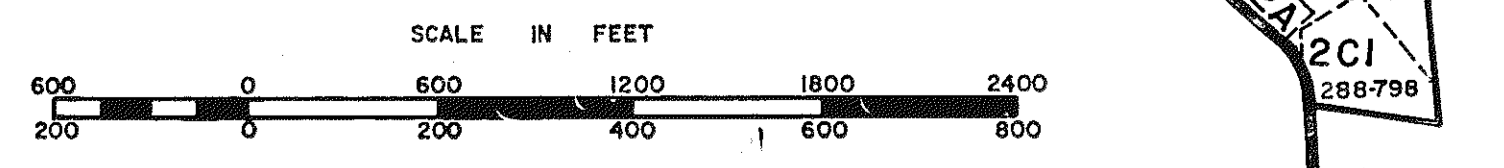
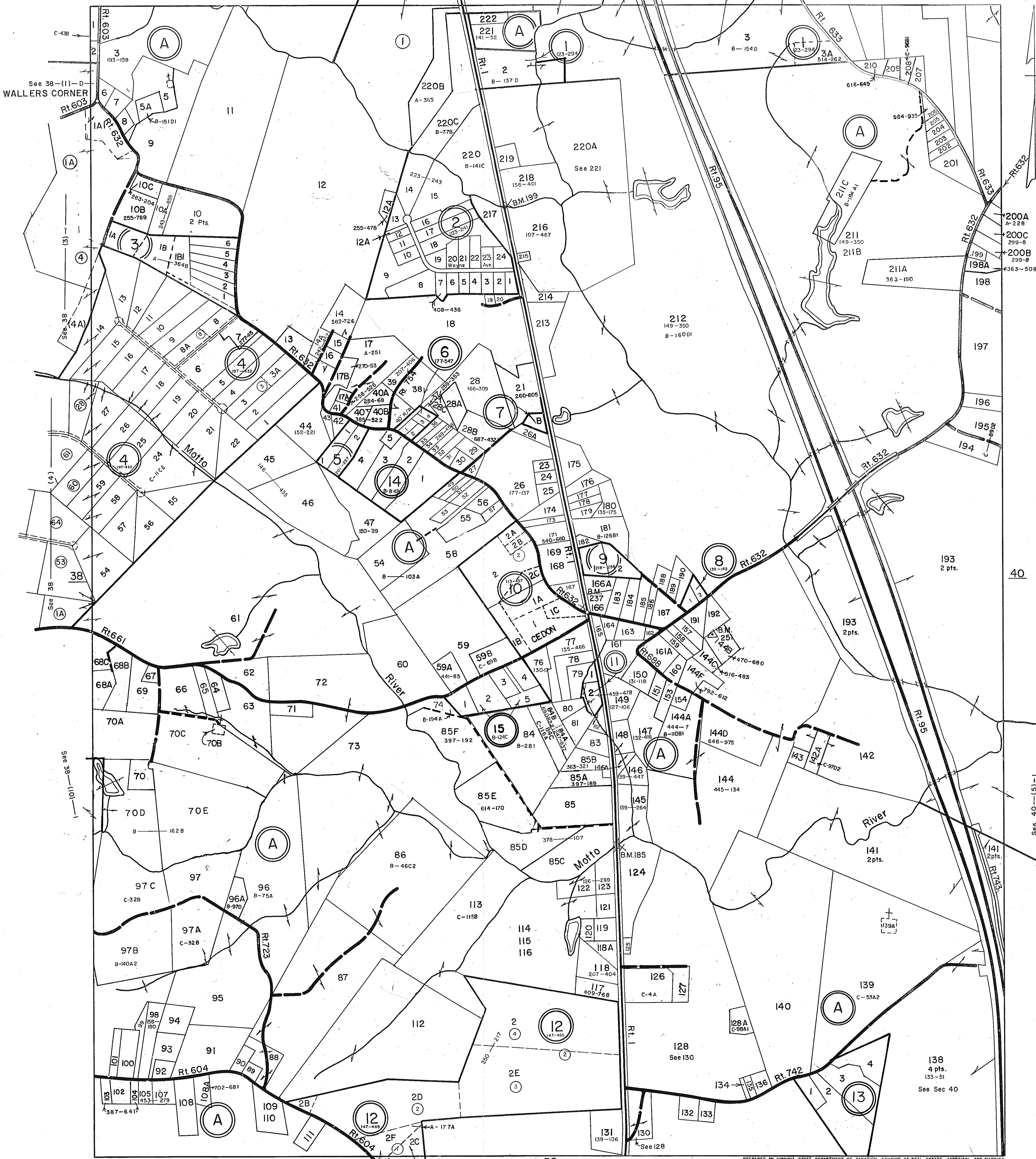

REVISED: 12-80,81,82,83,84,85,86,87,88,89,90,91,92,93,94,95,96,97,98,99,00,02,04,05

MADISON DISTRICT

SECTION 39
INSERT

PREPARED BY VIRGINIA STATE DEPARTMENT OF TAXATION, DIVISION OF REAL ESTATE APPRAISAL AND MAPPING