

CAROLINE COUNTY

NONE

NONE

R. F. & P. R.R.

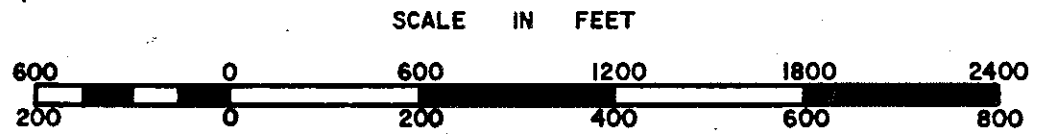
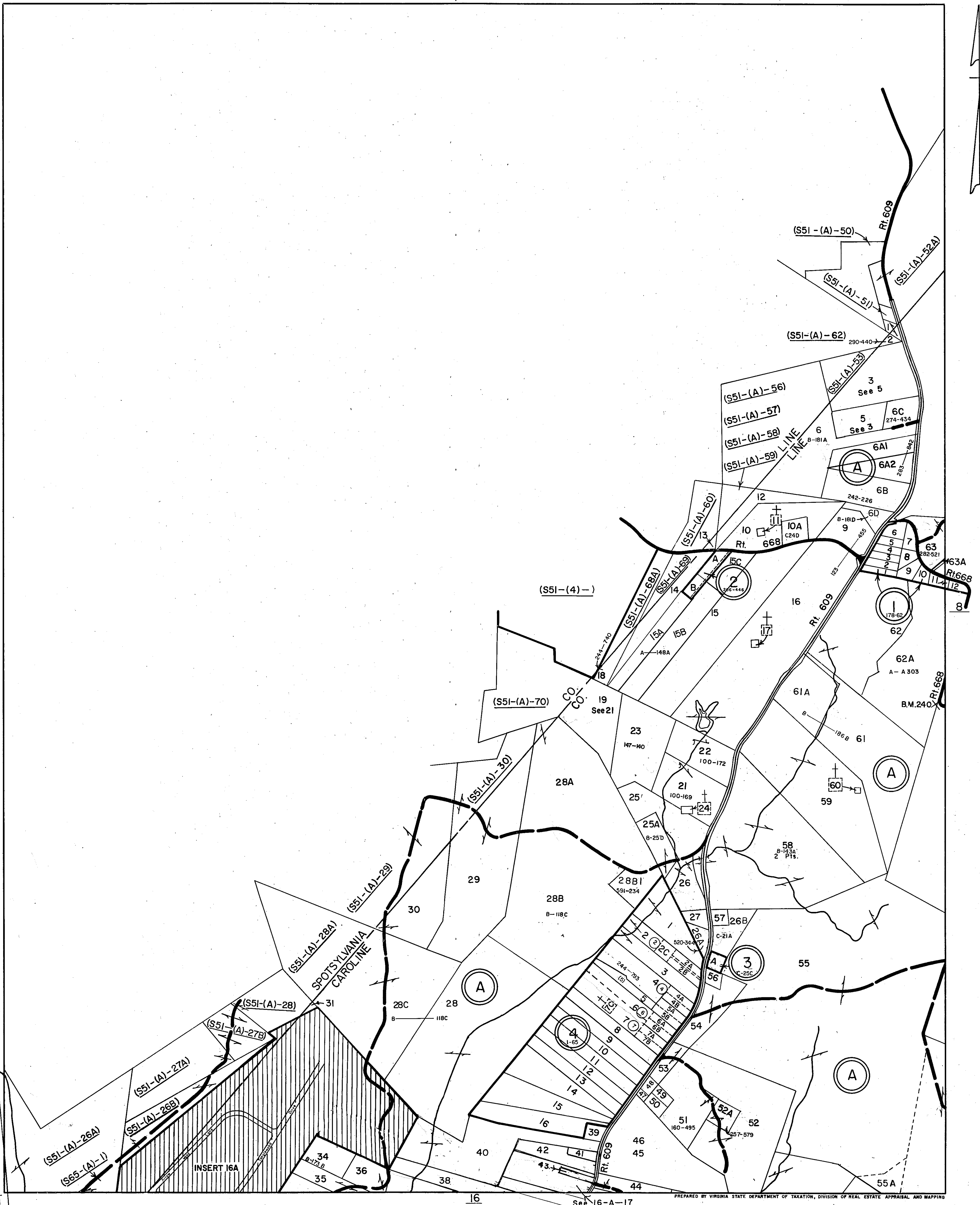

PORT ROYAL DISTRICT

SECTION 7  
INSERT

REVISED: 2004\_05

PREPARED BY VIRGINIA STATE DEPARTMENT OF TAXATION, DIVISION OF REAL ESTATE APPRAISAL AND MAPPING