

CAROLINE COUNTY

NONE

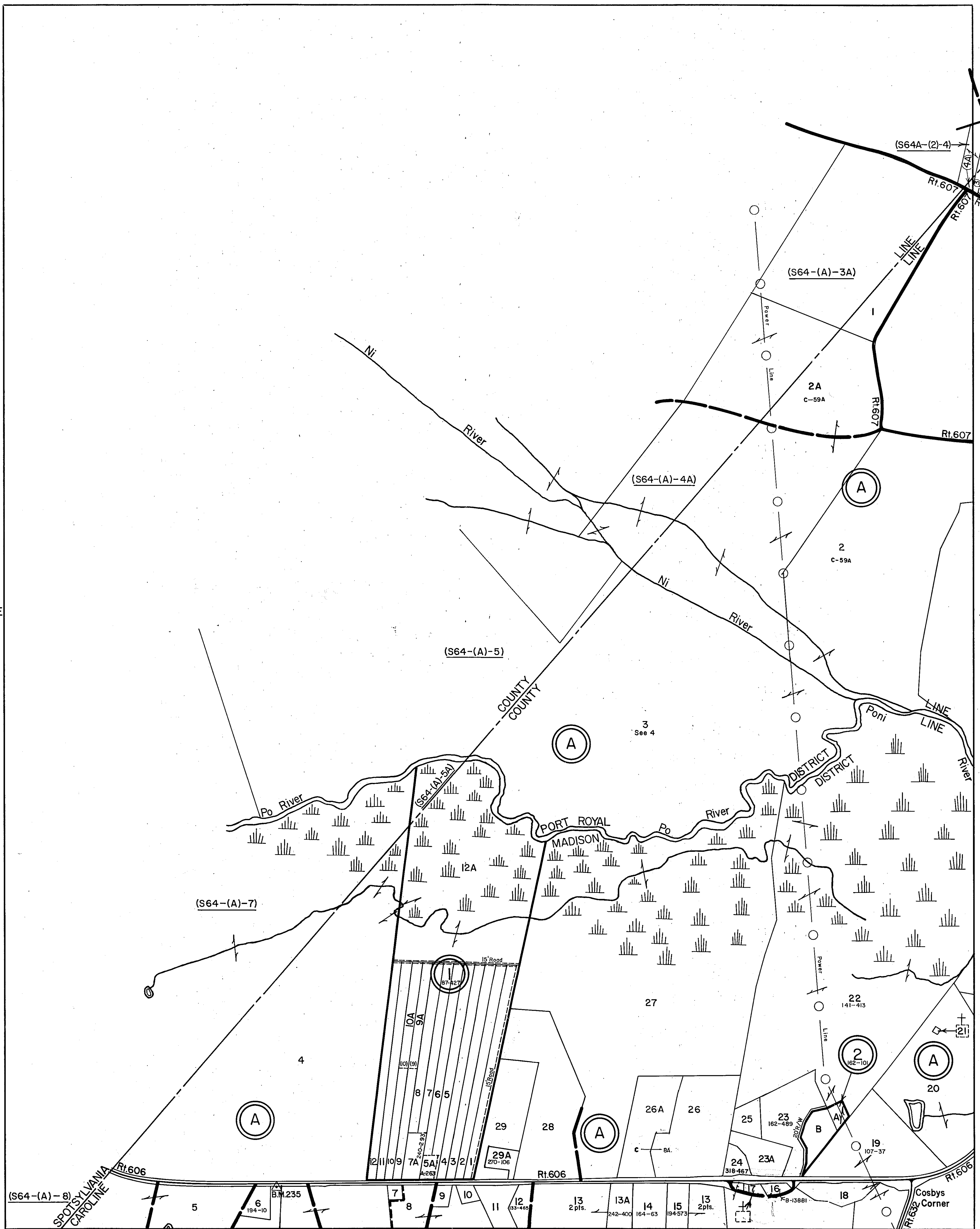

NONE

16

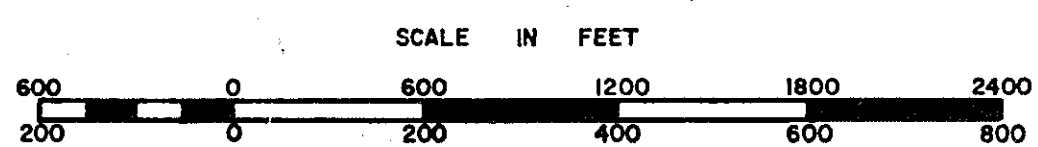

PORT ROYAL
MADISON DISTRICT

SECTION 15
INSERT

REVISED: 12-82,83,85,87,91 98 02 05

PREPARED BY VIRGINIA STATE DEPARTMENT OF TAXATION, DIVISION OF REAL ESTATE APPRAISAL AND MAPPING