

# CAROLINE COUNTY

15

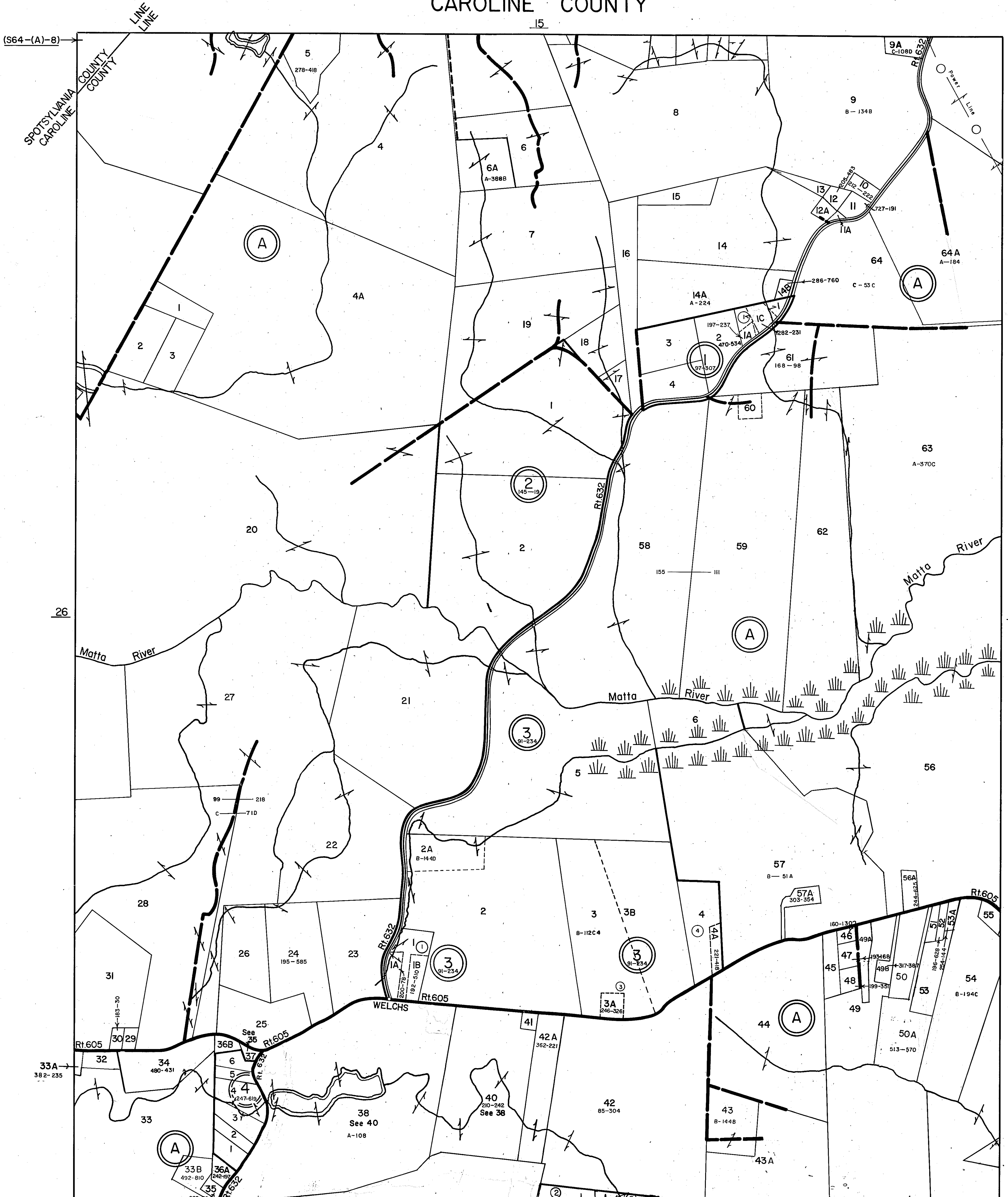

SPOTSYLVANIA COUNTY  
CAROLINE COUNTY  
LINE LINE

26

28

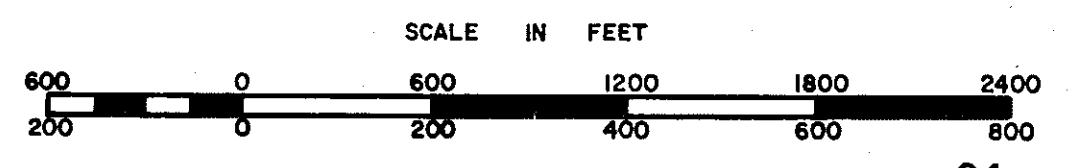

REVISED: 12-80, 81, 82, 83, 84, 86, 87, 88, 89, 90, 91, 92, 95, 96, 97, 98, 99, 02, 04, 05

MADISON DISTRICT

SECTION 27  
INSERT

PREPARED BY VIRGINIA STATE DEPARTMENT OF TAXATION, DIVISION OF REAL ESTATE APPRAISAL AND MAPPING